

Jewel Seatpost 2012

Basic Maintenance

- all you should know about -

(Feb 2012)

How to extract pneumatic cylinder?

How to regulate air pressure?

How to grease inside?

How to position magnets?

How to assemble pneumatic cylinder?



blacx

How to extract pneumatic cylinder? (1/4)

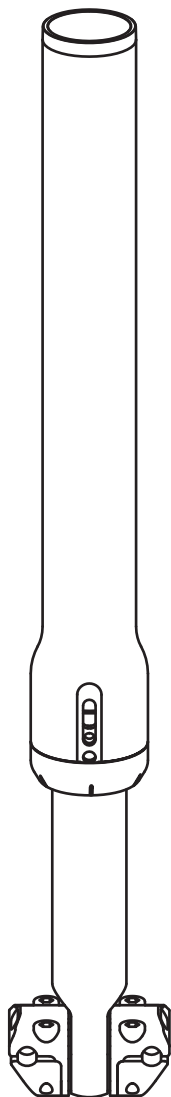

1

Clean the
seatpost with
a damp cloth



2

Unplug the
remote control
and screw
the thread cap
(see how on “Remote
control” techdoc)

How to extract pneumatic cylinder? (2/4)

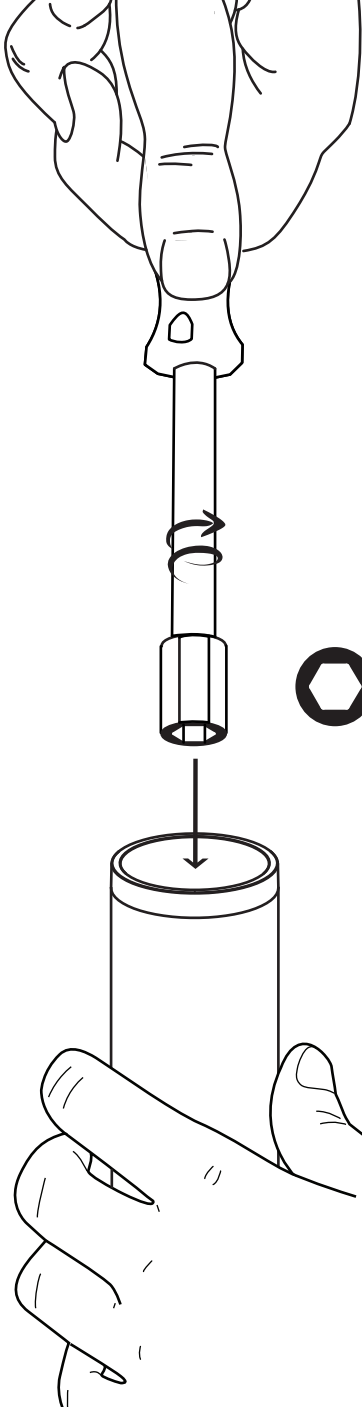

4

Introduce
box spanner
in the main tube
Fit it in the hex. valve
cap and unscrew.



TUBULAR BOX SPANNER
M10

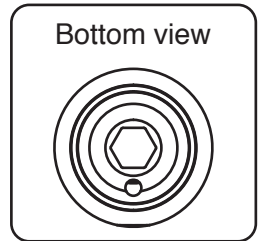

3

Maintains hand
pressing down.

How to extract pneumatic cylinder? (3/4)

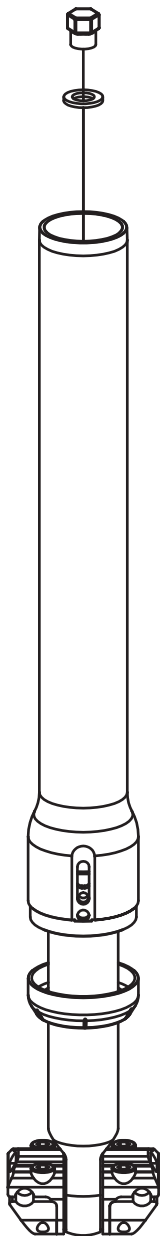

5

Extract the hex valve cap
and the *washer

*washer only in some models

6

Unscrew the thread cap

How to extract pneumatic cylinder? (4/4)

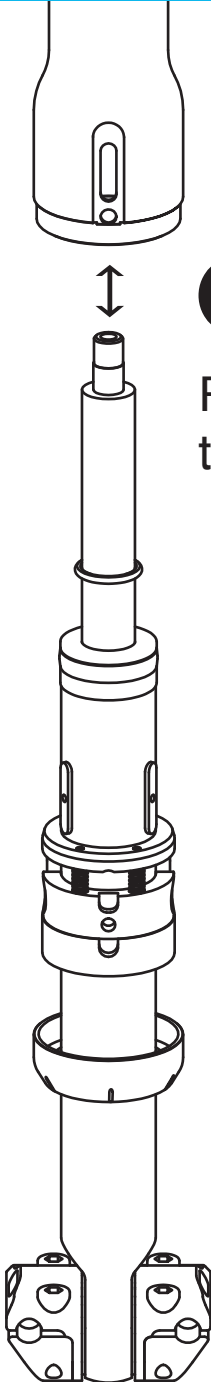

7

Pull out the main tube from the pneumatic cylinder

How to regulate air pressure?



Use a high pressure manometric pump

Recommended pressure: 110 psi

Recommended pressure range:
from 80 psi to 130 psi

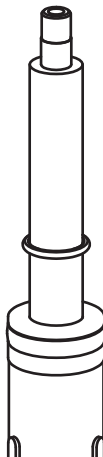

Important:
Manipulate it always
on extended position.

How to grease inside?

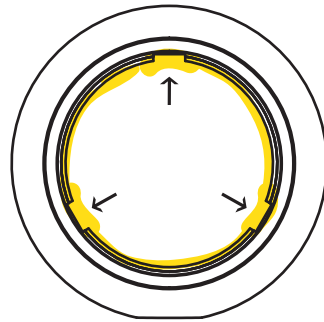
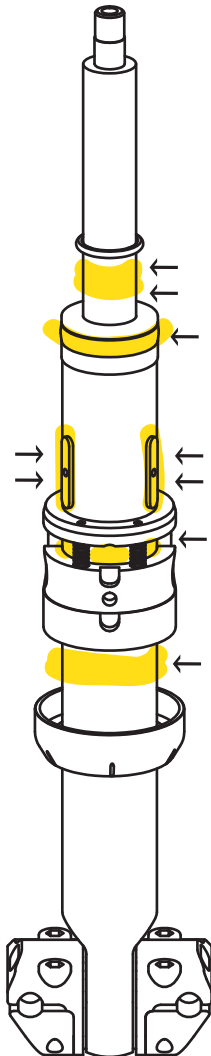

Areas to grease with a light film of silicone oil

Important:

we use a very high quality silicone oil life guaranteed.
Don't replace it if not necessary.

How to position magnets?



Positioned on the natural attraction direction of the magnetic fields.

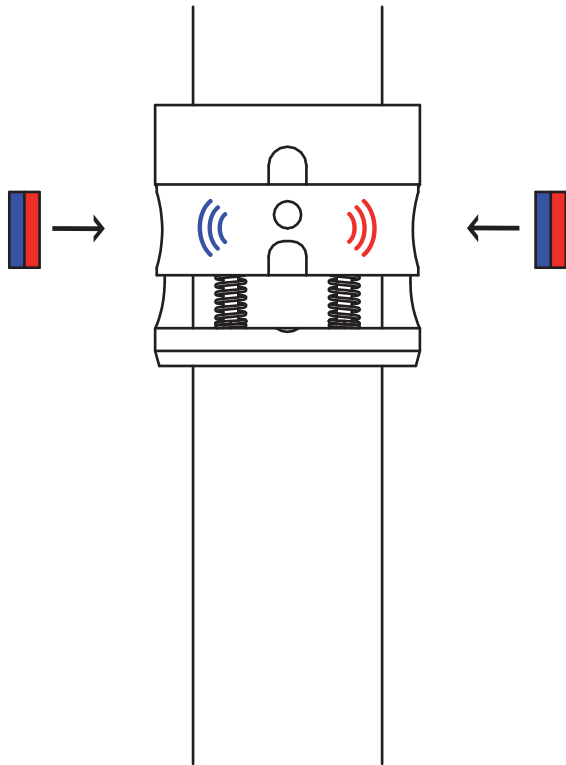

How to assemble pneumatic cylinder into the main tube? (1/4)



1

Put pneumatic cylinder into the main tube

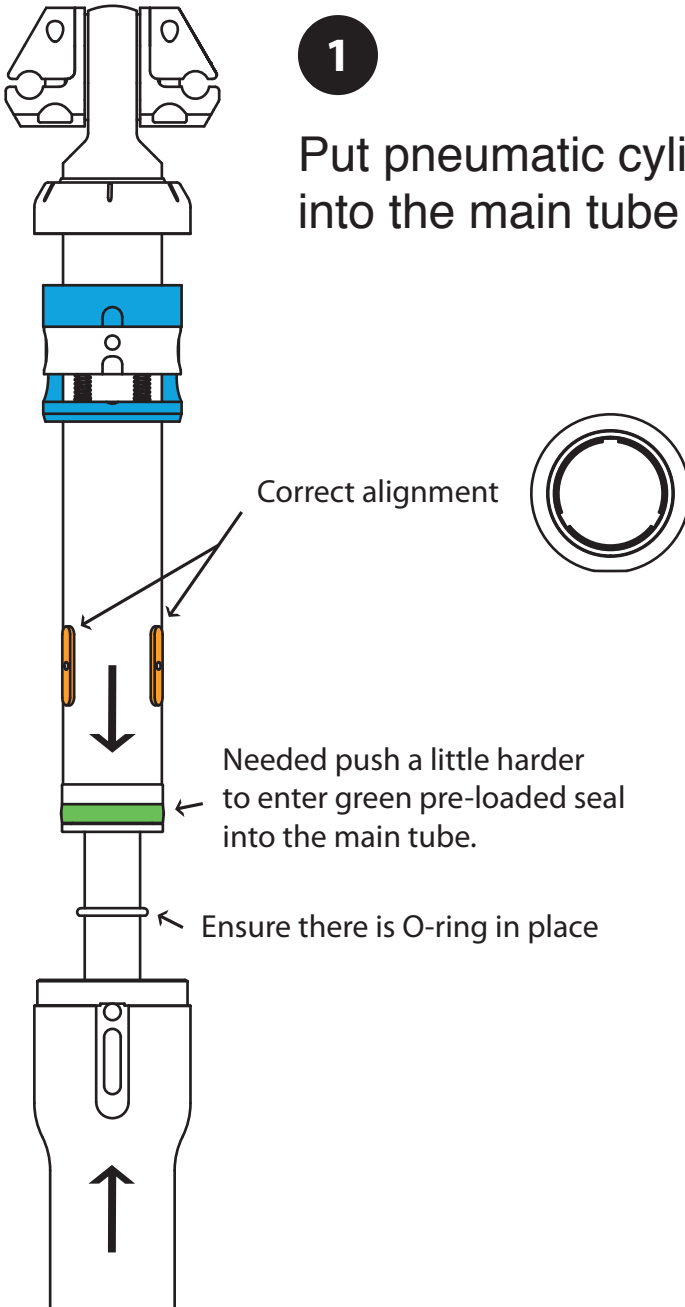

How to assemble pneumatic cylinder into the main tube? (2/4)



2

Push half bushing into the main tube. Align the sockets correctly.

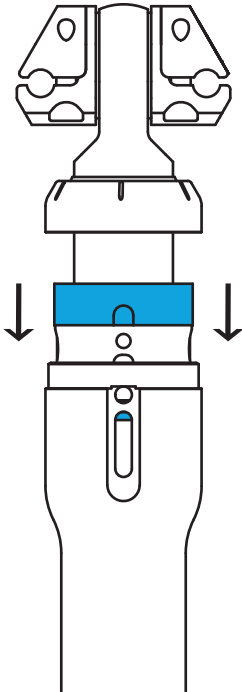

3

And push it in until complet insertion.

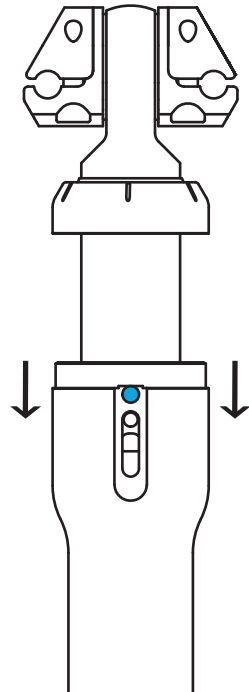

How to assemble pneumatic cylinder into the main tube? (3/4)

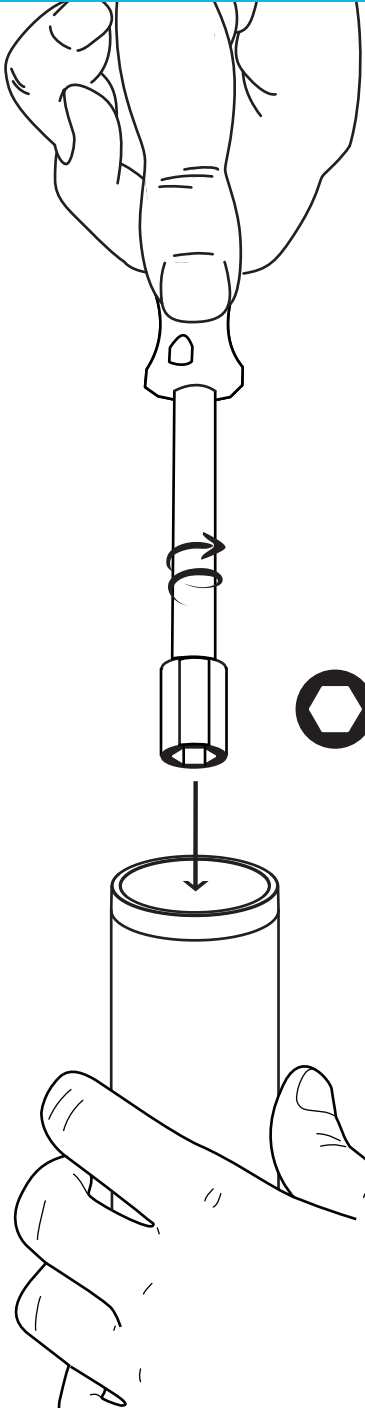

5



Fit the hex. valve cap into the valve.

Introduce the box spanner in the main tube, and screw it.



TUBULAR BOX SPANNER
M10

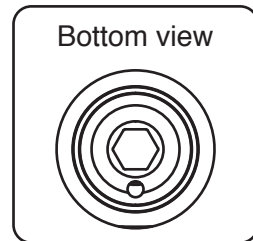

4

↓ Maintains hand pressing down.

How to assemble pneumatic cylinder into the main tube? (4/4)



6

**Plug the
remote control**
(see how on “Remote
control” techdoc)

